

WP-375

尺寸：280*100mm 單面黑白印刷

EVOLVEO

Chargee WL15

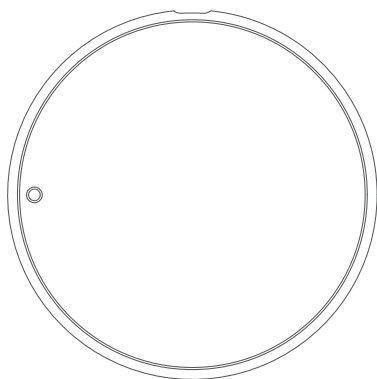

www.evolveo.com

Please use QC2.0 or 3.0 power adapter for fast charging function.

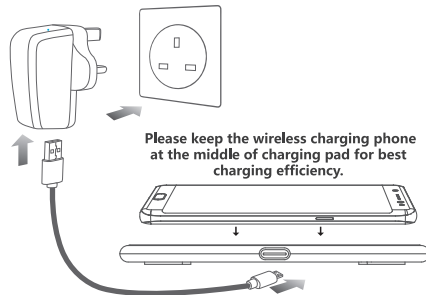

Specifications

| | |
|---------------------|-------------------------------------------------------------|
| Input | DC12V \approx 1.5A, DC9V \approx 1.67A, 5V \approx 2A |
| Output | 15W/10W/7.5W/5W |
| Product Standard | Qi |
| Charging Distance | \leq 10mm |
| Charging Efficiency | \leq 80% |
| Product Dimension | ϕ 93mm*6mm |
| Product Material | Aluminium alloy+Fluff Coating |

5V2A adapter is applicable to 5W standard wireless charging mode.

9V1.67A adapter is applicable to iPhone 7.5W fast wireless charging mode.

9V1.67A adapter is applicable to Samsung 10W fast wireless charging mode.

12V/1.5A adapter is applicable to 15W fast wireless charging mode.

※ **Fast wireless charging requires QC2.0/3.0 adapter or Samsung original fast charging adapter.**

Indicator light Status and Protection Function

Standby: Indicator light keeps green.

Charging: Indicator light keeps blue.

Fully Charged: Indicator light turn off.

FOD: The blue and green indicator light will flashing when put coin, keys, any metal or magnet objects on the charger.

perfect protection function based on over voltage protection, over current protection, over temperature protection and short circuit protection.

The indicator light will flash if the wireless charger not work well.

Attention

1. Please do not vigorously extrude or collide.
2. Please do not dismantle or put it into fire or water when the product is power on, to avoid short circuit or leakage.
3. Please do not use it in severely high temperature, high humidity or corrosive environment, to avoid damage to the circuit leakage.
4. Please do not put the magnetic strip or chip card (Such as ID card, bankcard etc.) on the charging pad to avoid to cause magnetic card lose efficacy.
5. Please do not put the metal (Such as coin etc.) on the charging pad when charging, to avoid damage from heating.

Note: This product is applicable to all Qi standard wireless charging phones, other phones need an external receiver for wireless charging function.

Dovozce / Dovožca / Importer / Importőr
Abacus Electric, s.r.o.
Planá 2, České Budějovice, Czech Republic

Výrobce / Výrobca / Manufacturer / Gyártó
Naxya Limited
No. 5, 17/F Bonham Trade Centre, 50 Bonham Strand, Sheung Wan, Hong Kong
Made in China

CE **!** DECLARATION OF CONFORMITY
Hereby, the company Abacus Electric, s.r.o. declares that the EVOLVEO Chargee CarWL15 is in compliance with the requirements of the standards and regulations, relevant for the given type of device.
Find the complete text of Declaration of Conformity at <ftp://ftp.evolveo.com/ce>



Disposal: The symbol of crossed out container on the product, in the literature or on the wrapping means that in the European Union all the electric and electronic products, batteries and accumulators must be placed into the separate salvage after finishing their lifetime. Do not throw these products into the unsorted municipal waste.